

AIR FORCE T.O. 35C2-3-442-14  
 ARMY TM5-6115-600-24P  
 NAVY NAVFAC P-8-628-24P  
 MARINE CORPS SL-4-07464B

SECTION II. REPAIR PARTS FOR ORGANIZATIONAL, INTERMEDIATE (FIELD)  
 (DIRECT AND GENERAL SUPPORT) AND DEPOT MAINTENANCE

(1) ILLUS- TRATION		(2) SMR CODE				(3) USMC		(4)	(5) DESCRIPTION		(6)	(7)	(8)
a	b	a	b	c	d	a	b	NATIONAL STOCK NUMBER	REF NUMBER & MFR CODE	USABLE ON CODE	U/M	QTY INC IN UNIT	USMC QTY PER EQUIP
FIG NO.	ITEM NO.	ARMY	AIR FORCE	NAVY	USMC	SSI	REPL FACTOR						
41									GROUP 05 - FUEL SYSTEM				
41	1	AFF	AFF	AHH	AHH				FUEL INJECTION VALVES AND LINES				
41	2	PAFZZ	PAFZZ	PAHZZ	PAHZZ		.008	2910-01-125-9799		VALVE ASSY, FUEL INJECTION 8N4698 11083	EA	6	6
41	3	PAFZZ	PAFZZ	PAHZZ	PAHZZ	D	.008	2910-00-477-3439		BODY ASSY, FUEL INJECTION 7N2626 11083	EA	6	6
41	4	PAFZZ	PAFZZ	PAHZZ	PAHZZ	D	.008	4730-00-363-9320		BODY 8S2389 11083	EA	6	6
41	5	PAFZZ	PAFZZ	PAHZZ	PAHZZ		.050	2910-01-125-9825		NUT 5H7225 11083	EA	6	6
41	6	PAFZZ	PAFZZ	PAHZZ	PAHZZ		.030	5330-00-198-6169		NOZZLE ASSY 8N4694 11083	EA	6	6
41	7	PAOZZ	PAFZZ	PAHZZ	PAHZZ		.030	5330-00-333-5032		PACKING, PREFORMED, P/O KIT P/N 5P8766 5B3718 11083	EA	6	6
41	8	AFF	AFF	AHH	AHH					SEAL ASSY, FUEL VALVE. P/O KIT P/N 5P8766 6F1069 11083	EA	6	6
41	9	PAOZZ	PAFZZ	PAOZZ	PAOZZ	D	.008	5305-01-131-5030		LINES, FUEL INJECTION (BASIC) 8N9616 11083	EA	1	1
41	10	PAOZZ	PAFZZ	PAOZZ	PAOZZ	D	.008	5340-01-116-1312		SCREW ASSY, MACHINE 6H9954 11083	EA	14	14
41	11	PAOZZ	PAFZZ	PAOZZ	PAOZZ	D	.008	5340-01-116-3799		CLAMP 6N6403 11083	EA	11	11
41	12	PAOZZ	PAFZZ	PAOZZ	PAOZZ	D	.008	5340-01-116-3799		CLAMP 6N6404 11083	EA	11	11
41	13	PAOZZ	PAFZZ	PAOZZ	PAOZZ	D	.008	5340-01-130-1964		CLAMP ASSY 7N3181 11083	EA	1	1
41	14	PAOZZ	PAFZZ	PAOZZ	PAOZZ	D	.008	5340-01-129-7839		CLAMP 8N9809 11083	EA	2	2
41	15	PAOZZ	PAFZZ	PAOZZ	PAOZZ	D	.005	5340-01-130-1963		CLAMP 8N9810 11083	EA	2	2
41	16	PAOZZ	PAFZZ	PAOZZ	PAOZZ	D	.005	4710-01-094		LINE ASSY, FUEL -1807 INJECTION (LINE 1) 7N2871 11083	EA	1	1
41	17	PAOZZ	PAFZZ	PAOZZ	PAOZZ	D	.005	4710-01-093		LINE ASSY, FUEL -7440 INJECTION (LINE 2) 7N2872 11083	EA	1	1
41	18	PAOZZ	PAFZZ	PAOZZ	PAOZZ	D	.005	4710-01-129		LINE ASSY, FUEL -8085 INJECTION (LINE 3) 8N9733 11083	EA	1	1
41	19	PAOZZ	PAFZZ	PAOZZ	PAOZZ	D	.005	4710-01-094		LINE ASSY, FUEL -1963 INJECTION (LINE 4) 7N2874 11083	EA	1	1
41	20	PAOZZ	PAFZZ	PAOZZ	PAOZZ	D	.005	4710-01-128		LINE ASSY, FUEL -4739 INJECTION (LINE 5) 8N9735 11083	EA	1	1
41	20	PAOZZ	PAFZZ	PAOZZ	PAOZZ	D	.005	4710-01-128		LINE ASSY, FUEL -4740 INJECTION (LINE 6) 8N9736 11083	EA	1	1

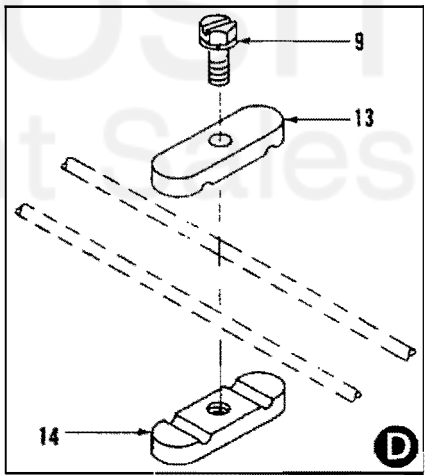
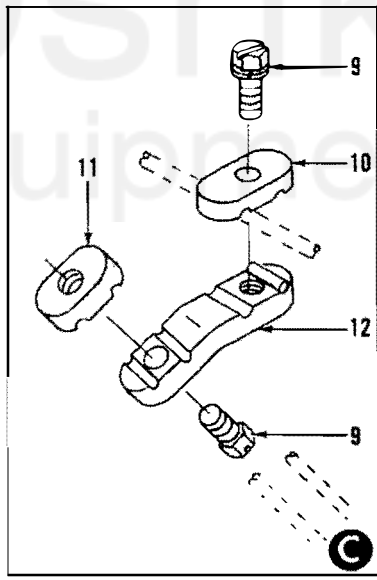
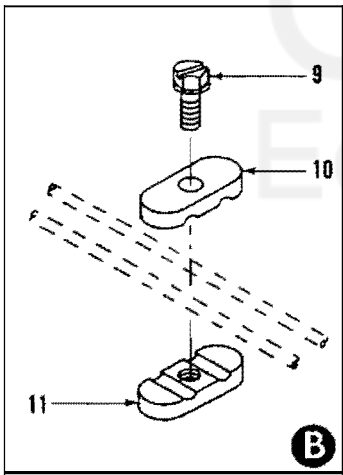
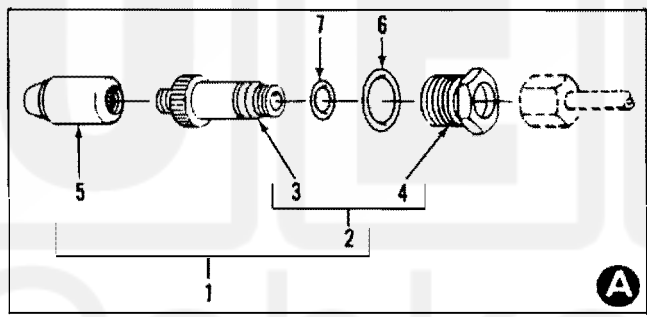
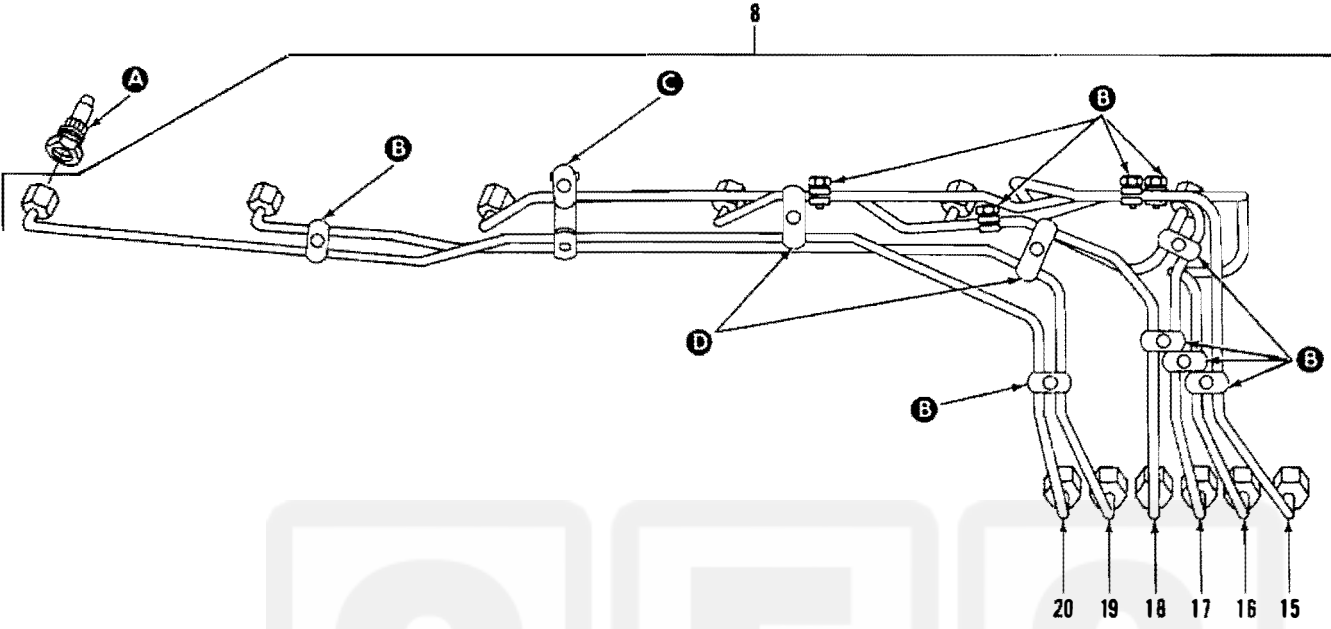

Figure 41. Fuel Injection Valves and Lines